

SPnorm & SPbloc Self Priming Centrifugal Pumps

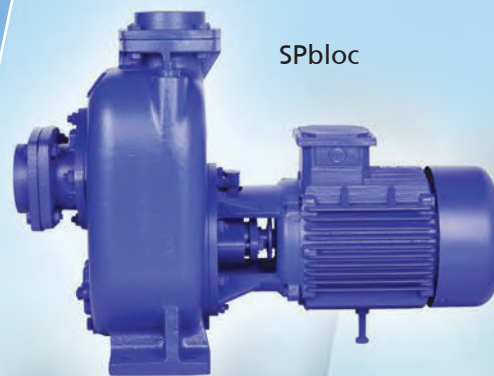

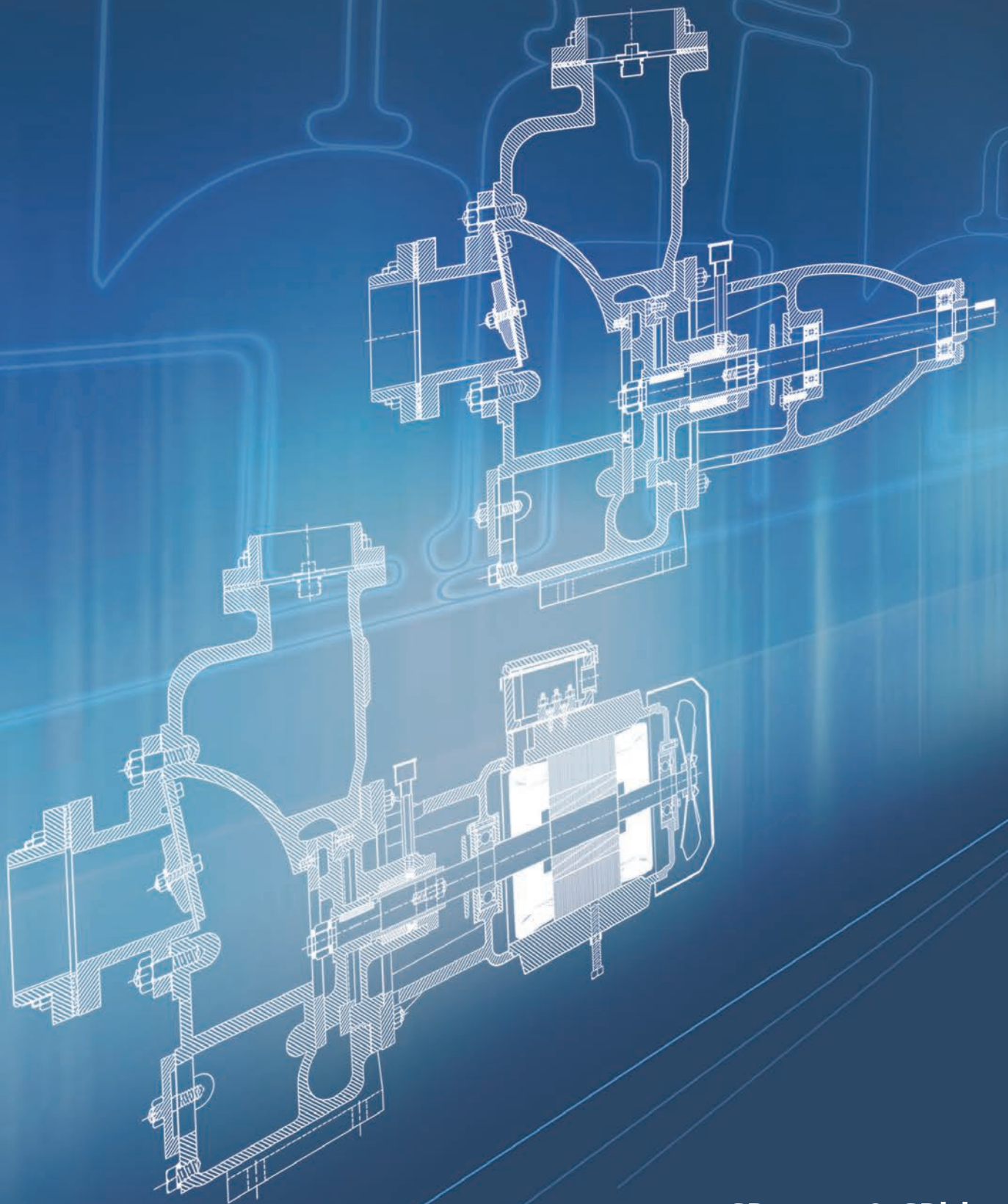

SPnorm & SPbloc
Self Priming Centrifugal Pumps

SPnorm & SPbloc - Self Priming Centrifugal Pumps



Design

SPnorm:

Horizontal self priming volute casing pumps, single stage with semi open impeller, in back pull out design. Long coupled on baseplate, suction lift up to 7 metres.

Technical specifications conforms to **IS 8472 & IS 8418**.

Performance Testing as per **IS 11346**.

SPbloc:

Horizontal self priming volute casing pumps, single stage with semi open impeller, in back pull out design. Monobloc, mono shaft design, hydraulics are assembled on extended motor shaft, suction lift up to 7 metres.

Technical specifications conforms to **IS 8472 & IS 8418**.







Performance Testing as per **IS 11346**.

Applications

Suitable pump for pumping

1. Muddy water, sewage, polluted liquids including solids etc.
2. Applications where priming & foot valve is to be avoided.

Industry wise Applications:

-  **Industrial:** Pumping petroleum products, chemicals, effluents, Sewage, ash-water etc
-  **Mobile Machinery:** Cooling water for marine engines & showels.
-  **Tiles & Marble industry:** for handling waste water.
-  **Civil Construction:** De-watering foundation, trenches and pits.
-  **Public utilities:** Sewage pumping.
-  **Marine:** Pumping water from docks, ports, vessels.

Technical Data

		SPbloc (monobloc)	SPnorm (barepump)
Head	m	6 to 36	6 to 50
Capacity	LPS	up to 19.4	up to 71
	m ³ /hr	up to 70	up to 253
Power rating	HP	1 to 7.5	1 to 25
	kW	0.75 to 5.5	0.75 to 18.5
DN size		DN 40, 50, 80	DN 40, 50, 80, 100, 150
MOC	Pump body	C.I.	C.I., SS
	Motor body	C.I.	-
	Impeller	C.I., SS, Bronze	C.I., SS, Bronze
	Wear plate	C.I., SS	C.I., SS
	Shaft	SS 410	SS 410, 316, 304
	Shaft sleeve	SS 410	SS 410, 316, 304
Sealing		Gland packing or mechanical seal	Gland packing or mechanical seal
Driver			Motor or Engine



Cross Sectional View - SPnorm 14 (Reference Drawing)

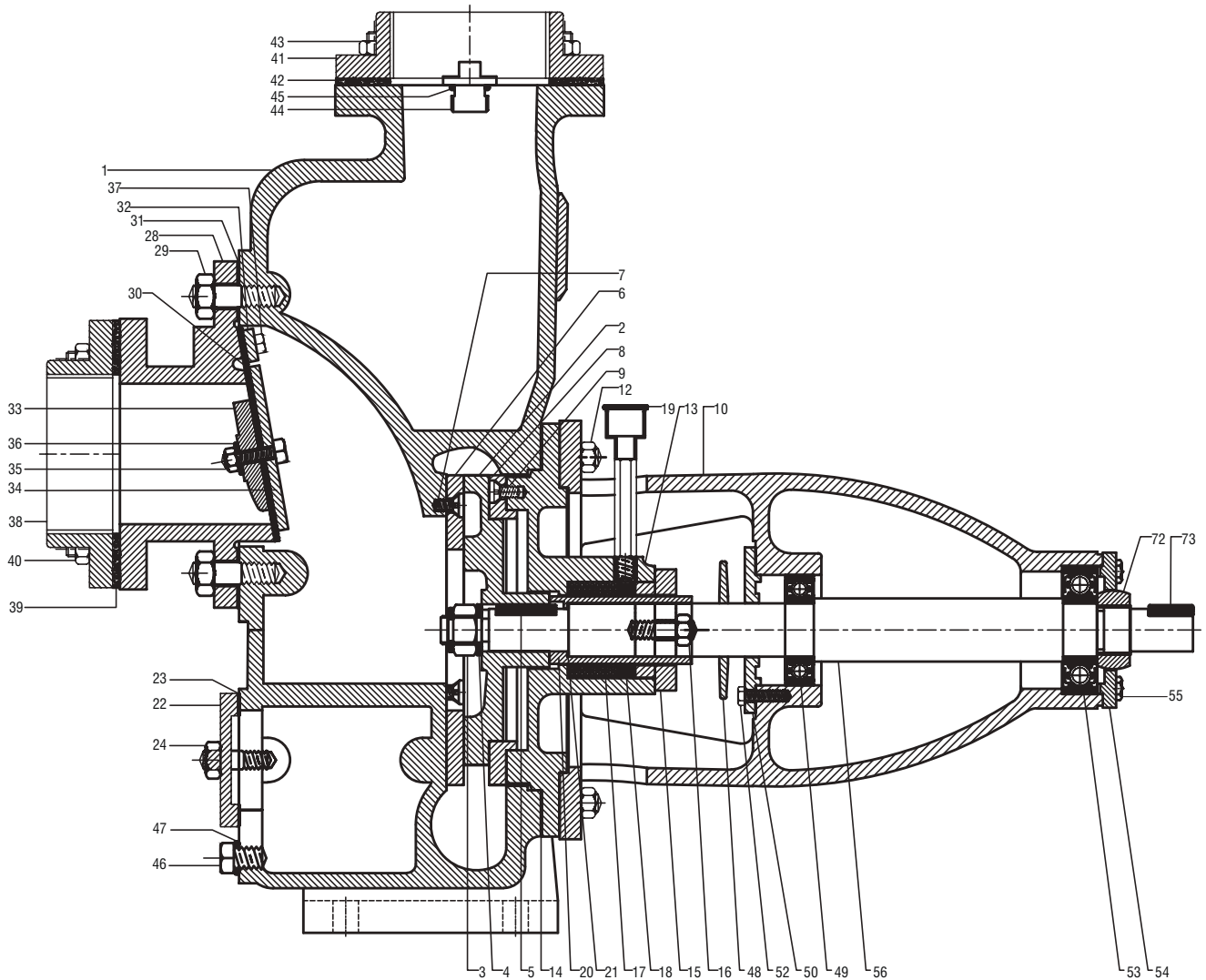

29	Stud with Nut for Suction housing	4	M.S.
28	Suction Housing	1	C.I. Gr. FG-260
24	Stud with Nut for Insp. window cover	2	M.S.
23	Packing for Insp. window cover	1	Paper
22	Insp window cover	1	C.I. Gr. FG-260
21	Gasket	1	Paper
20	Shaft Sleeve	1	S.S. Gr. AISI410
19	Grease Cup with Pipe Nipple	1	M.S.
18	Lantern ring	1	Plastic
17	Gland Packing	1 Set	Graphite Asbestos
16	Hex. bolt or Stud with Nut for Gland cover	2	M.S.
15	Gland Cover	1	C.I. Gr. FG-260
14	Packing for Stuffing Box Housing	1	Paper
13	Stuffing Box Housing	1	C.I. Gr. FG-260
12	Stud with Nut for Brg. housing & St. box housing	8	M.S.
11	Packing for Bearing housing	3	Paper
10	Bearing Housing	1	C.I. Gr. FG-260
9	Counter Sunk Screw for Wearing Plate	3	S.S. Gr. AISI304
8	Wearing Plate (DE)	1	C.I. Gr. FG-260
7	Counter Sunk Screw for Wearing Plate	3	S.S. Gr. AISI304
6	Wearing Plate (NDE)	1	C.I. Gr. FG-260
5	Key for Impeller Nut	1	M.S.
4	Washer for Impeller Nut	1	M.S.
3	Impeller Nut	1	M.S.
2	Impeller	1	C.I. Gr. FG-260
1	Pump Body	1	C.I. Gr. FG-260
Part no	Part Description	Qty	Material

73	Key for Coupling	1	M.S.
72	Bearing Lock Nut	1	M.S.
56	Rotar Shaft	1	CRNO Gr. M-47 & EN-8D
55	Cheese Head Screw for Bearing cover (DE side)	4	M.S.
54	Bearing Cover (DE side)	1	C.I. Gr. FG-260
53	Bearing (DE side)	1	Steel
52	Cheese Head Screw for Bearing cover (NDE side)	3	M.S.
50	Bearing Cover (NDE side)	1	C.I. Gr. FG-260
49	Bearing (NDE side)	1	Steel
48	Water Deflector	1	Rubber
47	O-Ring for Drain Plug	1	Rubber
46	Drain Plug	1	C.I. Gr. FG-260
45	O-Ring for Water Plug	1	Rubber
44	Water Plug (for Priming)	1	C.I. Gr. FG-260
43	Stud with Nut for Delivery flange	4	M.S.
42	Packing for Delivery flange	1	Rubber
41	Delivery flange	1	C.I. Gr. FG-260
40	Stud with Nut for Suction flange	4	M.S.
39	Packing Suction Flange	1	Rubber
38	Suction Flange	1	C.I. Gr. FG-260
37	Cheese Head Screw for Wt. fixing	2	M.S.
36	Washer for Flap valve	1	M.S.
35	Hex. bolt with Nut for Flap valve	1	M.S.
34	Weight for Flap valve (big)	1	C.I. Gr. FG-260
33	Weight for Flap valve (medium)	1	C.I. Gr. FG-260
32	Weight for Flap valve (Small)	1	C.I. Gr. FG-260
30	Flap valve	1	Nitril Rubber
Part no	Part Description	Qty	Material

Cross Sectional View - SPbloc 14M (Reference Drawing)

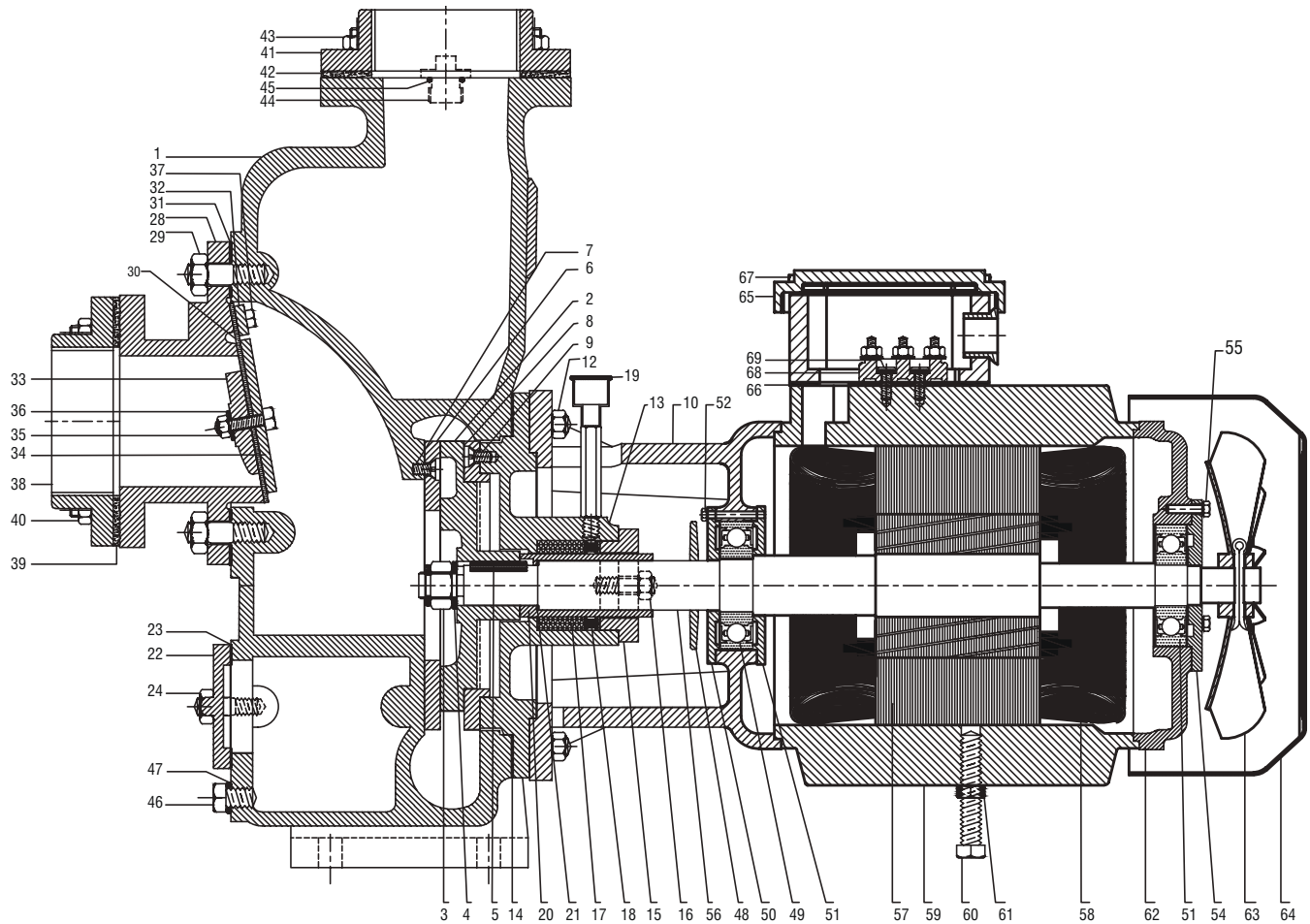

37	Cheese Head Screw for Wt. fixing	2	M.S
36	Washer for Flap valve	1	M.S.
35	Hex. bolt with Nut for Flap valve	1	M.S.
34	Weight for Flap valve (big)	1	C.I. Gr. FG-260
33	Weight for Flap valve (Medium)	1	C.I. Gr. FG-260
32	Weight for Flap valve (Small)	1	C.I. Gr. FG-260
31	Packing for Flap valve	1	Paper
30	Flap valve	1	Nitril Rubber
29	Stud with Nut for Suction housing	4	M.S.
28	Suction Housing	1	C.I. Gr. FG-260
24	Stud with Nut for Insp. window cover	2	M.S.
23	Packing for Insp. window cover	1	Paper
22	Insp window cover	1	C.I. Gr. FG-260
21	Gasket	1	Paper
20	Shaft Sleeve	1	S.S. Gr. AISI410
19	Grease Cup with Pipe Nipple	1	M.S.
18	Lantern ring	1	Plastic
17	Gland Packing	1 Set	Graphite Asbestos
16	Hex. bolt or Stud with Nut for Gland cover	2	M.S.
15	Gland Cover	1	C.I. Gr. FG-260
14	Packing for Stuffing Box Housing	1	Paper
13	Stuffing Box Housing	1	C.I. Gr. FG-260
12	Stud with Nut for Brg. housing & St. box housing	8	M.S.
10	Bearing Housing	1	C.I. Gr. FG-260
9	Counter Sunk Screw for Wearing Plate	1	S.S. Gr. AISI304
8	Wearing Plate (DE)	1	C.I. Gr. FG-260
7	Counter Sunk Screw for Wearing Plate	3	S.S. Gr. AISI304
6	Wearing Plate (NDE)	1	C.I. Gr. FG-260
5	Key for Impeller Nut	1	M.S.
4	Washer for Impeller Nut	1	M.S.
3	Impeller Nut	1	M.S.
2	Impeller	1	C.I. Gr. FG-260
1	Pump Body	1	C.I. Gr. FG-260
Part No.	Description	Qty	Material

69	Cheese Head Screw for Terminal	4	M.S.
68	Terminal	1	Bakelite
67	Cheese Head Screw for Terminal Box	4	M.S.
66	Packing for Terminal Box	1	Rubber
65	Terminal Box	1	C.I. or M.S. Sheet
64	Fan Cover	1	M.S. Sheet
63	Fan	1	Plastic
62	End Cover	1	C.I. Gr. FG-260
61	Washer for Motor Adjustment Bolt	1	M.S.
60	Motor Adjustment Bolt	1	M.S.
59	Motor Body	1	C.I. Gr. FG-260
58	Stator Winding	1	Copper
57	Stator	1	CRNO Gr. M-47
56	Rotor Shaft	1	CRNO Gr. M-47 & EN-8D
55	Cheese Head Screw for Bearing cover (DE side)	4	M.S
54	Bearing Cover (DE side)	1	C.I. Gr. FG-260
53	Bearing (DE side)	1	Steel
52	Cheese Head Screw for Bearing cover (NDE side)	4	M.S
51	Bearing Cover (In Side)	1	C.I. Gr. FG-260
50	Bearing Cover (Out side)	1	C.I. Gr. FG-260
49	Bearing (NDE side)	1	Steel
48	Water Deflector	1	Rubber
47	O-Ring for Drain Plug	1	Rubber
46	Drain Plug	1	C.I. Gr. FG-260
45	O-Ring for Water Plug	1	Rubber
44	Water Plug (for Priming)	1	C.I. Gr. FG-260
43	Stud with Nut for Delivery flange	4	M.S.
42	Packing for Delivery flange	1	Rubber
41	Delivery flange	1	C.I. Gr. FG-260
40	Stud with Nut for Suction flange	4	M.S
39	Packing Suction Flange	1	Rubber
38	Suction Flange	1	C.I. Gr. FG-260
Part No.	Description	Qty	Material



CONTACT INFO



A-228, Udhna Udhyog Sangh, Road No. 10,
Udhna, Surat - 394210.

T-21, Silver Plaza, Nr. Sardar Patel Complex,
G.I.D.C., Ankleshwar - 393002.



+91-72111 76202
+91-78781 46717



sales@infinitygroupindia.com
nimish@infinitygroupindia.com